



# SEA 7157

## VHF/FM DSC Radiotelephone



- **Marine VHF/FM and Class A DSC Radiotelephone**
- **24 VDC or 12 VDC versions**
- **Distress key with protective cover**
- **NMEA 0183 interface for GPS position**
- **Alpha numeric keypad for ease of operation**
- **Large graphic display that is sunlight viewable**
- **Full 25 Watts power output with 1 Watt function**

The SEA 7157 is a Class A DSC VHF/FM marine radiotelephone within the SEA product line of high quality VHF and HF/MF SSB marine radio products. The SEA 7157 has the embedded capability for Digital Selective Calling which is ITU & IMO compliant for GMDSS.

SEA is a leading manufacturer of Marine radiotelephone and GMDSS equipment worldwide, and the SEA 7157 is an important product within its GMDSS product line. As added value to the SEA 7157, we provide the capability to support Ship to Shore Radio-telephone services by supporting telephone calls through automated Coastal stations.

Automated DSC distress calls can be activated and transmitted directly to Coast Guard and other GMDSS equipped vessels within range. Your distress call can be automatically received and responded to via continual automated sending of your position and type of distress.

Users of SEA products have always relied upon and received reliable and high quality world-class radiotelephones and the SEA 7157 continues this long tradition. The SEA 7157 radio design incorporates modern technology in RF architecture, LCD displays, and other radio components.

SEA has a worldwide service network to support all of its GMDSS products. This ensures backup support almost anywhere in the world your ship is operating. To learn more about the SEA 7157 or other products in the SEA product lines, contact your local Marine Electronics Dealer or call SEA COM CORP at (425) 771-2182, or email [sales@seacomcorp.com](mailto:sales@seacomcorp.com).

# SEA 7157 Specifications

## GENERAL

### Frequency Range:

155 to 163.6 MHz

### Number of Channels:

All US, Canada, International and 10 weather channels.

### Input Voltage:

24 Vdc +30% -10%  
12 Vdc ± 15%

### Current Drain:

Standby: 24V .25A,  
2V.5A

Receive: 24V .3A,  
12V .6A

Transmit: 25W 24V 3A,  
12V 6A

Transmit: 1W 24V .75A,  
12V 1.5A

### Compliance:

FCC Part 80, 15.GMDSS (Para 80.1101). EIA RS 204C, RS 152B, IMO A 694(17) and A 609(15), ETS 300 338, Y2K

### FCC ID:

BZ6SEA7157

### Safe Compass Distance:

1 meter

## TRANSMITTER

### Frequency Range:

155 to 159 MHz

### Frequency Stability:

±5ppm, -30 to +60°C (FCC, EIA)

### Power Output:

25W, 1W into 50Ω

### Audio Response:

6dB per octave pre-emphasis 300 – 3000 Hz

### Audio Distortion:

Less than 10% (EIA)

### Spurious & Harmonic Radiation:

At least 60dB below rated carrier

### Spurious Emissions (Radiated):

-60dB or better

### Spurious Emission (Conducted):

-60dB or better

## PRIMARY RECEIVER

### Frequency Range:

155 to 163.6 MHz

### Sensitivity:

Less than .3uV for 12dB SINAD

### Selectivity:

-80dB at 25 KHz  
-85dB at ≥ 50 KHz (EIA)

### IM Ratio:

At least 80dB

### Spurious and Image Rejection:

At least 80dB

### Audio Output:

4W, less than 10% distortion into 4Ω

### Channel 70 Watch Receiver:

Conforms to ETS 300 338 and IEC 1097-8

## DSC OPERATION

### Navigation Interface:

NMEA 018 compatible with GPS and reads RMA, RMC, GLL, and GGA sentence formats.

### Clock:

Date and time of day, battery backed

### Calling Formats:

All formats per ITU-R M493-8 Class A

### ITU Recommendations:

498-8 and 541-6

### IMO Resolutions:

A 694(17) and A 803(19)

### Memory:

Non volatile memory for Unit ID, Individual and Groups, up to 49 frequently called DSC ID's, 49 telephone numbers with associated alphabetic names, 40 most recent Distress and Urgency calls plus 40 other calls.

## Dimensions

In. (mm)

7.75 lbs (3.5 kgs)

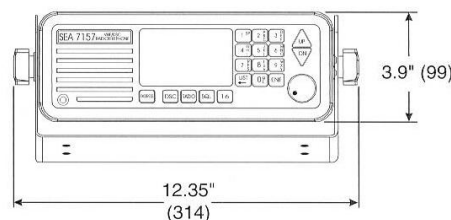
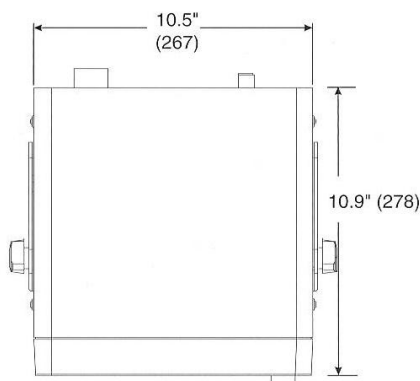

## SEA COM CORPORATION

7030 - 220<sup>th</sup> S.W., Mountlake Terrace, Washington 98043, 425.771.2182 Fax: 425.771.2650 www.seacomcorp.com